

Linear units with toothed belt drive

LEZ 3

Guides
and shaft slides
also available stainless.



with shaft slide



with trolley

Features

- Aluminium profile, miniature linear guide LFS-8-4
- No-play feed with toothed belt drive, toothed belt with 5 mm interval, width 25 mm
- Max. feed. 5 m/s
- Shaft slides WS3, L176 × W130 mm
- Feed per turn: 70 mm or 150 mm
- Repeat accuracy less than or equal to ± 0.2 mm
- Limit or reference switch accuracy < 0.1 mm
- Available in lengths up to 6,000 mm
- Motor modules can be flange-mounted on left or right side

Accessories can be found on page B-100.

Options:

- Special 100 mm raster lengths available to order, max. 6000 mm

Ordering key

23200X XXXX

Profile lengths (mm)

698, 998, 1498, 1998, 2498, 2998

(e. g. 698 mm = 070
1498 mm = 150)

Feed

6 = 150 mm / turn

7 = 70 mm / turn

Slides, trolley

0 = with shaft slides

1 = with trolley

Technical specification

| | |
|---|---|
| Belt type..... | HTD 5M, width 25 mm |
| Slide weight..... | 0.940 kg |
| Weight without drive module..... | 1000 mm ¹ = 10.5 kg |
| specific weight of the toothed belt..... | 0.09 kg/m |
| Roller carriage weight..... | 2.03 kg |
| specific guide weight..... | 0.648 kg/100 mm |
| Feed per turn..... | 70 mm or 150 mm |
| Effective diameter of the synchronous disks | |
| Feed 70 mm/turn..... | 22.28 mm |
| Feed 150 mm/turn..... | 47.75 mm |
| Moment of inertia of the synchronous disks | |
| Feed 70 mm/turn..... | 5.58E-6 kgm ² |
| Feed 150 mm/turn..... | 1,796.10 ⁻⁴ kgm ² |

Load diagram

Permitted accelerated weights relative to the belt strength.*

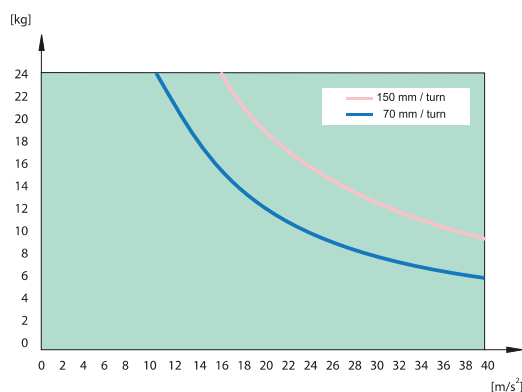

* with vertical construction, the acceleration due to gravity (g=9.81 m/s²) must be considered

Bending data can be found on page B-27.

Linear units

with toothed belt drive

LEZ 3

Dimensioned drawings

with shaft slides

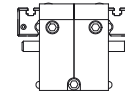
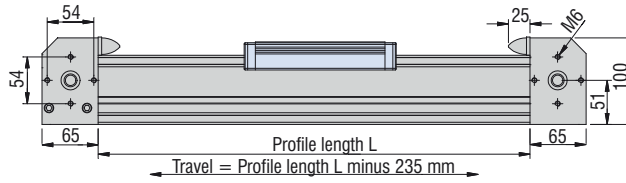
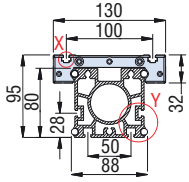

Feed: 70 mm/turn

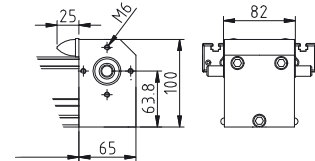
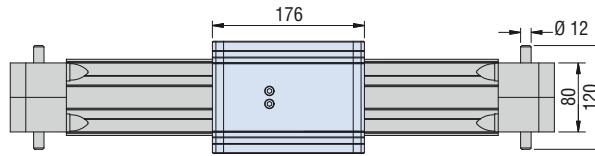
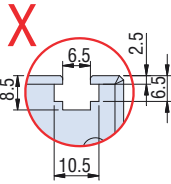

with trolley

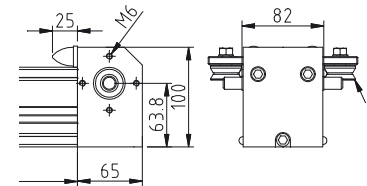
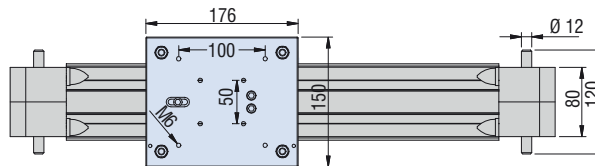
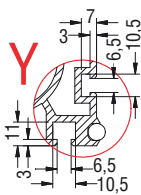
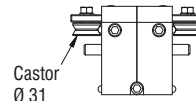
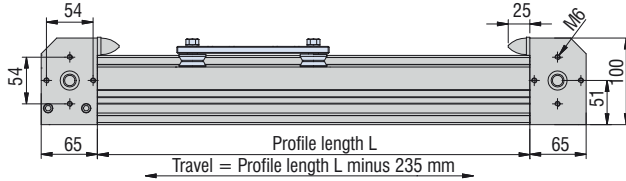
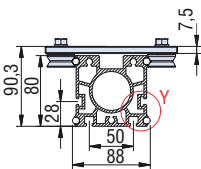

Motor modules

(Motor pin assignments are on Page B-74)

Drive module with stepper motor
(direct drive)

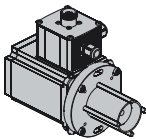

| Part number | Motor module | |
|--------------|--------------|-------|
| 396 085 0060 | MS 600 HT | right |
| 396 085 0061 | MS 600 HT | left |
| 396 088 0060 | MS 900 HT | right |
| 396 088 0061 | MS 900 HT | left |

Drive module with EC servomotor
EC 60 and EC 86 (direct drive)

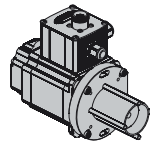

| Part number | Motor module |
|----------------|--------------|
| 396 423 006012 | EC 60L |
| 396 444 0070 | EC 86S |
| 396 466 0070 | EC 86L |

